

**NOTICE!!**

**These documents have been scanned!**

**Do not place un-scanned documents beneath this notice!**

**Do not remove this notice from this file!**

GPO Jacket No. 560-102  
Print Order 61540  
Rise Business Services, LLC  
Job=AZ15 7/11/2019



Box Number= AZ15155



Claim Begin-End: AMC452337-AMC452337

**1 Initial Receipt**



AZ15155-37

AMC452349-AMC452348

**United States Department of the Interior**  
**Bureau of Land Management**  
 DIV OF LANDS, MINRLS & ENERGY  
 ONE N CENTRAL AVE  
 PHOENIX, AZ 85004 -4427  
 Phone: 602-417-9200

Receipt

No: 4288264

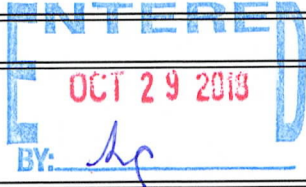
<b>Transaction #:</b> 4404308	
<b>Date of Transaction:</b> 10/22/2018	
CUSTOMER:	
KURT JOHNSON 8408 WOODLAND PRAIRIE AVE LAS VEGAS, NV 89129-8237 US	

LINE #	QTY	DESCRIPTION	REMARKS	UNIT PRICE	TOTAL
1	1.00	LOCATABLE MINERALS / MINING CLAIMS-NEW, UNADJUD, ONE OR MORE AUTH NOS / NEW MINING CLAIM PROCESSING FEE <b>CASES: AMC452337/\$20.00</b>		- n/a -	20.00
2	1.00	LOCATABLE MINERALS / MINING CLAIMS-NEW, UNADJUD, ONE OR MORE AUTH NOS / NEW MINING CLAIMS LOCATION FEE <b>CASES: AMC452337/\$37.00</b>		- n/a -	37.00
3	1.00	LOCATABLE MINERALS / MINING CLAIMS-NEW, UNADJUD, ONE OR MORE AUTH NOS / NEW MINING CLAIMS MAINTENANCE FEE <b>CASES: AMC452337/\$155.00</b>		- n/a -	155.00
<b>TOTAL:</b>					<b>\$212.00</b>

PAYMENT INFORMATION			
1	AMOUNT:	212.00	POSTMARKED: N/A
	TYPE:	CHECK	RECEIVED: 10/19/2018
	CHECK NO:	25088197588	
	NAME:	JOHNSON, KURT 8408 WOODLAND PRAIRIE AVE LAS VEGAS NV 89129-8237 US	

REMARKS

This receipt was generated by the automated BLM Collections and Billing System and is a paper representation of a portion of the official electronic record contained therein.

**NOTICE!!**

**These documents have been scanned!**

**Do not place un-scanned documents beneath this notice!**

**Do not remove this notice from this file!**

GPO Jacket No. 560-102  
Print Order 61540  
Rise Business Services, LLC  
Job=AZ15 7/11/2019



Box Number= AZ15155



Claim Begin-End: AMC452337-AMC452337

**2 Correspondence**



AZ15155-37

AMC452349-AMC452348

**NO  
DOCUMENTS  
FOUND**

NO DOCUMENTS FOUND  
NO DOCUMENTS FOUND

**NOTICE!!**

**These documents have been scanned!**

**Do not place un-scanned documents beneath this notice!**

**Do not remove this notice from this file!**

GPO Jacket No. 560-102  
Print Order 61540  
Rise Business Services, LLC  
Job=AZ15 7/11/2019



Box Number= AZ15155



Claim Begin-End: AMC452337-AMC452337

**3 Transfers**



AZ15155-37

AMC452349-AMC452348

**NO  
DOCUMENTS  
FOUND**

NO DOCUMENTS FOUND  
NO DOCUMENTS FOUND

**NOTICE!!**

**These documents have been scanned!**

**Do not place un-scanned documents beneath this notice!**

**Do not remove this notice from this file!**

GPO Jacket No. 560-102  
Print Order 61540  
Rise Business Services, LLC  
Job=AZ15 7/11/2019



Box Number= AZ15155



Claim Begin-End: AMC452337-AMC452337

**4 Annual Filings**



AZ15155-37

AMC452349-AMC452348

**NO  
DOCUMENTS  
FOUND**

NO DOCUMENTS FOUND  
NO DOCUMENTS FOUND



**NOTICE!!**

**These documents have been scanned!**

**Do not place un-scanned documents beneath this notice!**

**Do not remove this notice from this file!**

GPO Jacket No. 560-102  
Print Order 61540  
Rise Business Services, LLC  
Job=AZ15 7/11/2019



Box Number= AZ15155



Claim Begin-End: AMC452337-AMC452337

**5 Miscellaneous**

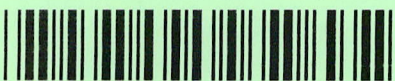

AZ15155-37

AMC452349-AMC452348

**NO  
DOCUMENTS  
FOUND**

NO DOCUMENTS FOUND  
NO DOCUMENTS FOUND

**NOTICE!!**

**These documents have been scanned!**

**Do not place un-scanned documents beneath this notice!**

**Do not remove this notice from this file!**

GPO Jacket No. 560-102  
Print Order 61540  
Rise Business Services, LLC  
Job=AZ15 7/11/2019



Box Number= AZ15155



Claim Begin-End: AMC452337-AMC452337

**6 Location Notices-Amendments and Supporting Documents**



AZ15155-37

AMC452349-AMC452348



Copy

LOCATION NOTICE FOR PLACER MINING CLAIM

Amendment BLM Serial # \_\_\_\_\_

NOTICE IS HEREBY GIVEN that the Big KURT  
Claim placer mining claim has been located by  
KURT JOHNSON whose current mailing  
address is 8408 WOODLAND PRAIRIE AVE  
LAS VEGAS, NV 89129

BLM  
Date  
Stamp

PHOENIX, ARIZONA

2018 OCT 19 P 1:58

RECEIVED  
BLM AZ STATE OFFICE

The general course of this claim is North to South and it is situated in Mohave  
County, Arizona. This claim is 1320 feet in length and 660 feet in width.

20 Total Claim Acreage. This claim runs from the location monument on which this location notice is  
posted at the NE corner of the claim approximately 1320 feet in a South direction to the  
South end line and 660 feet in a West direction to the West end line. This claim is  
marked by four monuments, one at each corner of the claim.

The location monument on which this notice is posted is situated within Section 32 Township  
29 N Range 18 W Gila Salt River Base and Meridian, Arizona. This claim encompasses  
portions of the following legal subdivision(s) if located by legal subdivision or the following quarter section(s).  
section(s), Township(s) and Range(s) NE 1/4 of section 32, T29N, R18W, G+SRM  
Gila Salt River Base and Meridian, Arizona.

The locality of this claim with reference to some natural object or permanent monument and additional information  
(if any) concerning its locality are as follows: The NE corner of this claim is  
660 feet west of the NE corner of section 32, T29N, R18W, G+SRM

\_\_\_\_\_ The above information is shown on the attached map.  
DATED AND POSTED on the ground this 03 day of OCT, 2018.

LOCATOR(s)  AGENT

Print Name(s) KURT JOHNSON  
Signature(s) [Signature]

Form MCF102  
Revised July 2014

This form is available from the Arizona Geological Survey and may be reproduced.

AMC452337

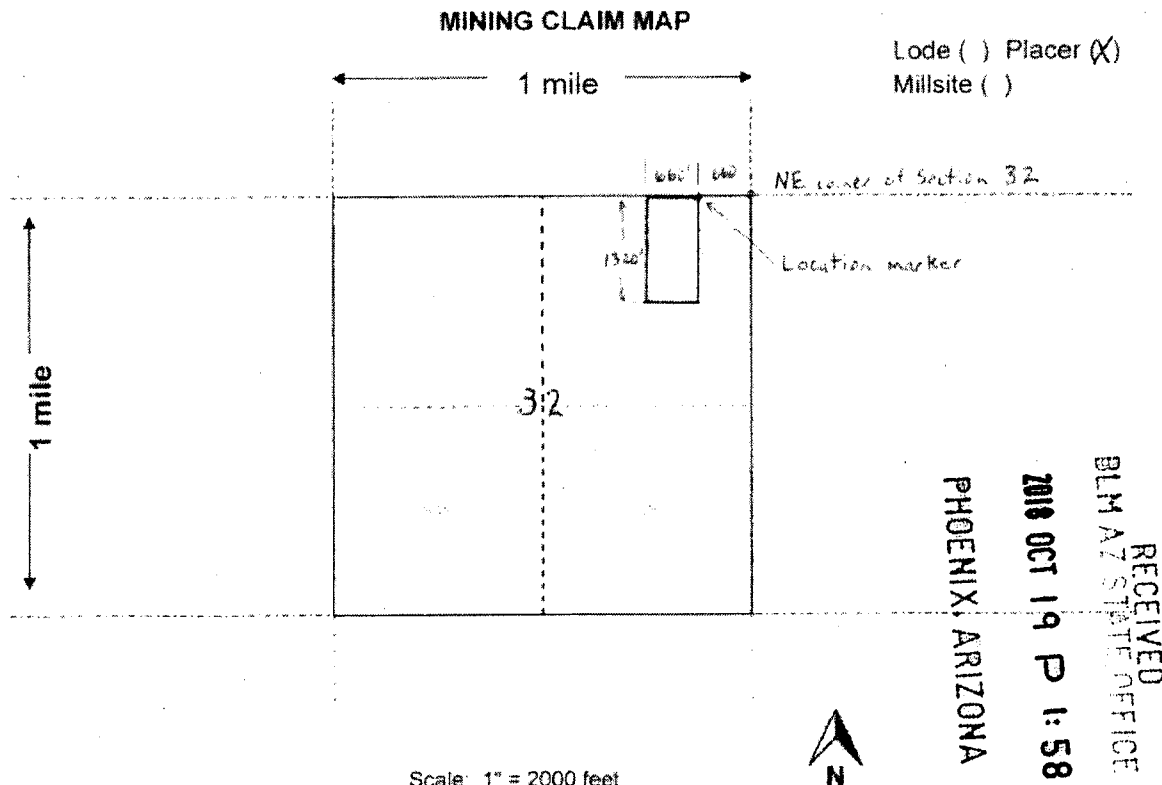

- Scale: 1" = 2000 feet
- The above map depicts the Big KURT claim mining claim, which is located in Section (s) 32, Township 29 N, Range 18 W, Gila and Salt River Base and Meridian, Mohave County, Arizona. Total claim acreage is 20
  - The type of corner and location monuments used are as follows: 4x4 wood post 4 feet tall
  - The bearings and distances in degrees and feet between claim corners and to a public land survey monument are as depicted on the map.
  - If the claim is a placer or millsite claim with exterior limits conforming to legal subdivisions of the public survey, provide a legal description of the claim W 1/2 NE 1/4 NE 1/4 of section 32  
T 29 N, R 18 W, G+SRM

Form MCF100a  
Revised July 2014

This form is available from the Arizona Geology Survey and may be reproduced.

AMC452337

LR2K Home

CR-24



# LR2000 Internal

## CR Geographic Report with Land

[Download User Guide \(pdf\)](#)

Purpose: This report produces a geographic listing of case information based on retrieval by Meridian/Township/Range. This report format will display the case type, case disposition, meridian, township, range, section, survey type, survey number, surface management agency, pending actions, serial number, and total case acres.



### No Results

The specified criteria didn't result in any data. This is often caused by applying filters and/or selection steps that are too restrictive or that contain incorrect values. Please check your analysis filters and selection steps, and try again. The filters or selection steps currently being applied are shown below.

#### Filters

Disposition is equal to **AUTHORIZED, CANCELLED, EXPIRED, PENDING, REJECTED, RELINQUISHED, WITHDRAWN**  
and Meridian Township Range Section is equal to **14 0290N 0180W 032 NE**  
and Admin State is equal to **AZ**

[Return](#) - [Refresh](#)





**PRIORITY<sup>®</sup>**  
**★ MAIL ★**

UNITED STATES  
POSTAL SERVICE.

Retail

**P**

US POSTAGE PAID  
**\$6.70**

Origin: 89018  
Destination: 85004  
0 Lb 1.50 Oz  
Oct 17, 18  
3142700260-03

1006

**PRIORITY MAIL 2-Day<sup>®</sup>**

EXPECTED DELIVERY DAY: 10/19/2018

**C041**

USPS TRACKING NUMBER



9505 5100 5127 8290 0455 87



PS00001000014

EP14F July 2013  
OD: 12.5 x 9.5

FROM:

**PRIORITY<sup>®</sup>**  
**★ MAIL ★**

UNITED STATES  
POSTAL SERVICE<sup>®</sup>

VISIT US AT [USPS.COM](http://USPS.COM)<sup>®</sup>  
ORDER FREE SUPPLIES ONLINE

FROM:

KURT Johnson  
8408 Woodland Prairie Ave  
Las Vegas NV 89129

TO: BLM

1 N. CENTRAL AVE, Suite 800  
Phoenix, AZ 85004-4427

Label 228, March 2016

FOR DOMESTIC AND INTERNATIONAL USE

VISIT US AT [USPS.COM](http://USPS.COM)<sup>®</sup>  
ORDER FREE SUPPLIES ONLINE

UNITED STATES  
POSTAL SERVICE<sup>®</sup>

This packaging is the property of the United States Postal Service and is provided solely for use in sending Priority Mail. All rights reserved. Misuse may be a violation of federal law. This packaging is not for resale. EP14F © U.S. Postal Service; July 2013; All rights reserved.

**PRIORITY<sup>®</sup>**  
**★ MAIL ★**



**FLAT RATE ENVELOPE**  
ONE RATE ★ ANY WEIGHT\*

RECEIVED  
BLM AZ STATE OFFICE  
2018 OCT 19 P 1:58  
PHOENIX, ARIZONA

